

Township of Leslie

4279 Oak – POB 577
Leslie, Michigan 49251
517-589-8201
517-589-0010 (Fax)

AGRICULTURAL ZONING APPROVAL

Date Issued: _____

Parcel # _____

COMPLETE ALL APPLICABLE SECTIONS: INCOMPLETE APPLICATIONS WILL BE RETURNED

	SIZE	FEE
New Agricultural Building		N/C
Agricultural Building Alterations or Additions		N/C
Demolition		N/C
Miscellaneous		N/C

OFFICE USE:

Site Plan Drawing _____ **Soil & Erosion Permit** _____ **Well/Septic** _____
Site Inspection _____ **Driveway Permit** _____

Property Owner _____ Daytime Phone Number _____

Property Owner Email _____

Exact Location of Work Site _____ Nearest Crossroad _____

Contractor's Name (Please Print) _____ Business Name _____

Contractor's Address _____ City _____ State _____ Zip _____

Contractor's Telephone Number _____ Fax Number _____

License Number _____ Expiration Date _____

Contractor's Signature _____ Email _____

As property owner, I certify that this building will be used solely for agricultural purposes as defined in the Right to Farm Act (Act 93 of 1981). I understand if this building is used for any other purpose, it may require a change of use permit, current residential building permit, and would need to be brought into compliance with all other residential codes in effect at the time of (and for) the change of use. I also certify that the location of property lines is true and correct as identified in the site plan submitted to the Zoning Enforcement Official. If the location of the property lines is incorrect, I am responsible for identifying the property lines and moving the building if necessary.

PROPERTY OWNER'S SIGNATURE _____ Date _____

DALLAS HENNEY 517-589-8201
LESLIE TOWNSHIP ZONING ADMINISTRATOR

SITE PLAN - Draw the location of all existing and proposed structures on the parcel. Be sure to include footage from lot lines to all structures and footage from one structure to another (existing and proposed).

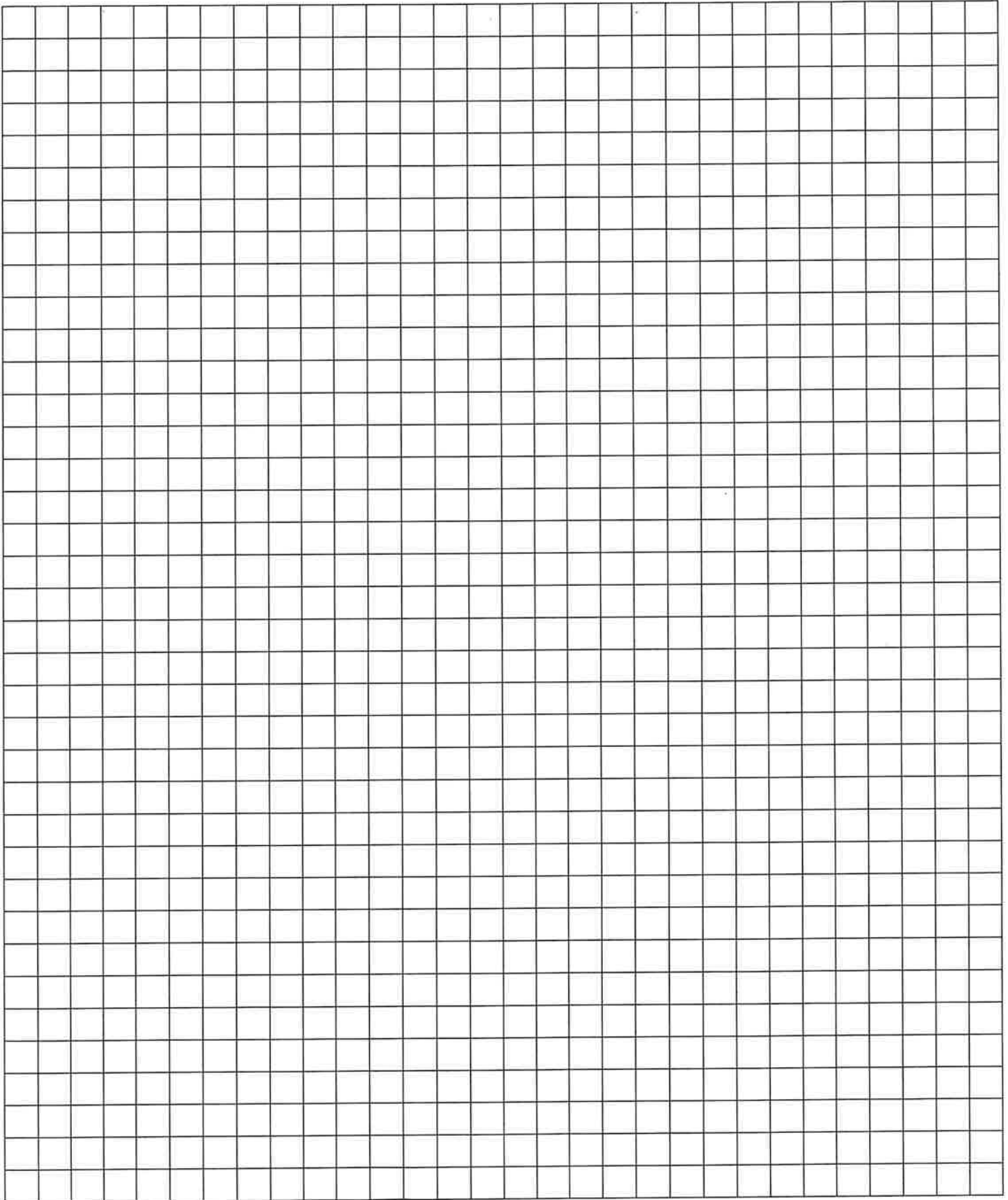

INDICATE DIRECTION OF NORTH POINT:

VIII. SITE PLAN - FOR APPLICANT USE

N

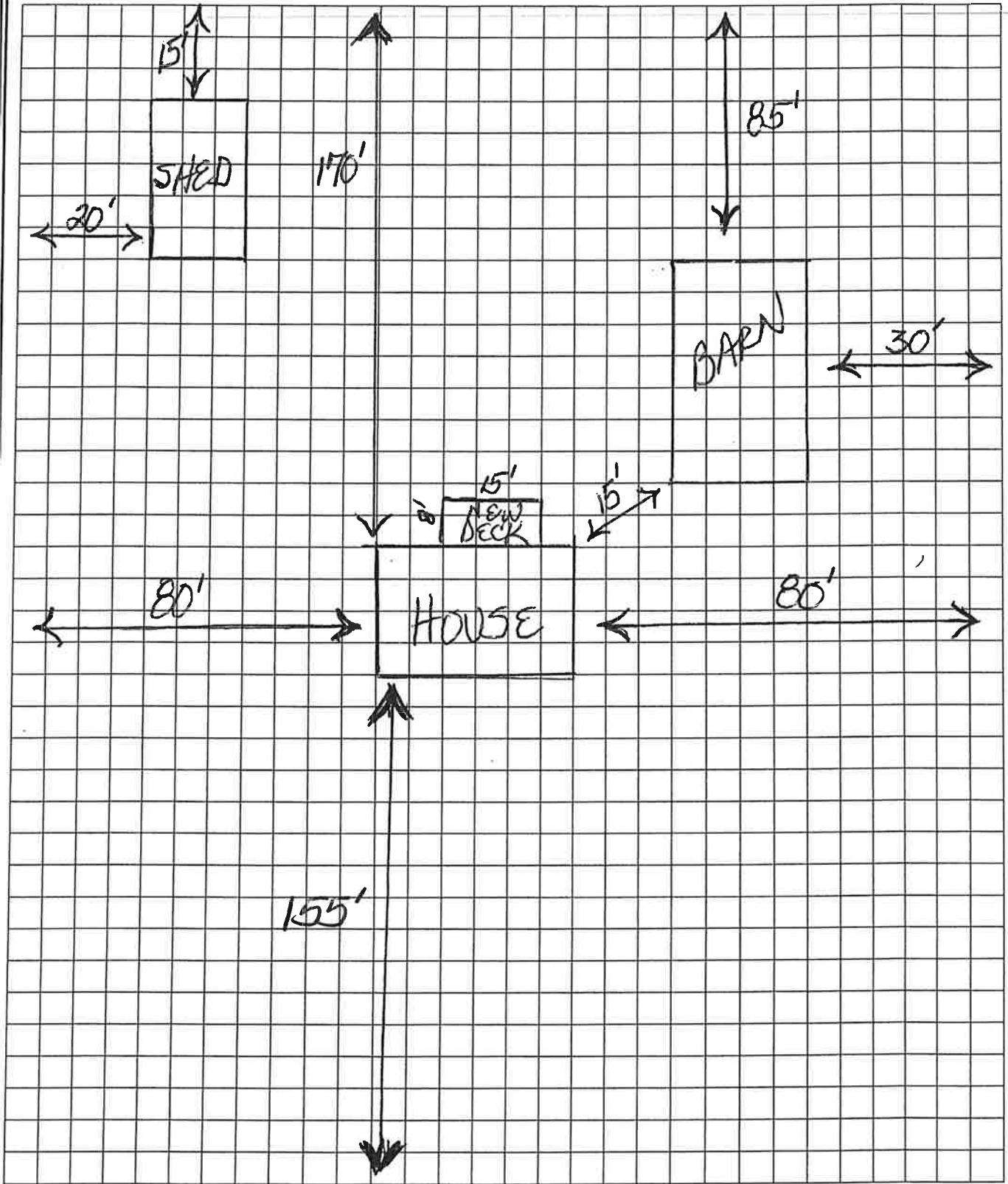

INDICATE DIRECTION OF NORTH POINT:

ROAD

SAMPLE SITE PLAN